



St Peter's Halliwell Parish Profile

New Role of Associate Minister



St. Peter's Parish Centre
347 Church Road Bolton
BL1 5RR
www.stpetersparish.info
Tel: 01204 599900



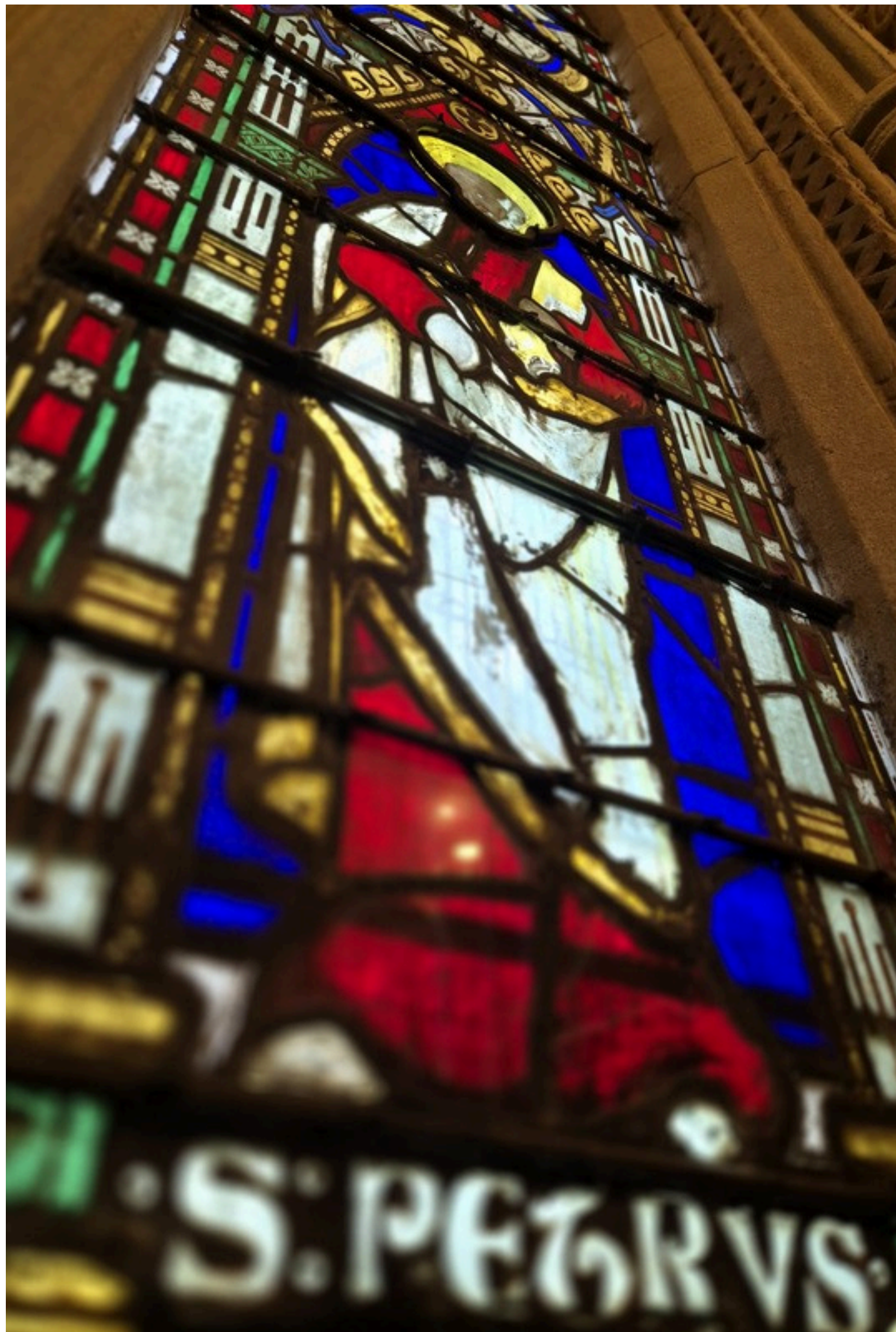

CONTENTS

A Note from the Vicar 3

About St Peter's – Who We Are

Our Purpose 4

Our Fellowships 5

Our Parish 7

Our Buildings 8

Our Staff 9

Our Town 12

St Peter's Ministry – What We Do

Worship Services 13

Discipleship and Evangelism 13

Youth and Children 16

Pastoral Care and Local Outreach 17

Community Connections 18

Global and local Mission 19

Accessibility 19

The Future of St Peter's – Where We Are Going

Five Key Areas 21

Church Plant 23

Front Lines 23

Ministry to Older People 24

Parish Centre 24

Appendices

Housing 25

Governance 27

Finances 28

Manchester Diocese 29

General Information 29

A Note from the Vicar, Alan Saunders...

Could God be calling you to St Peter's?

I am hugely excited for the future of St Peter's Parish, and I am passionate and committed to see St Peter's fulfil its vision to have a significant impact across Bolton and beyond. I believe with the right person; St Peter's has huge potential to grow and release new leaders.

As an evangelist and visionary, I would love to work with and minister alongside someone who shares my passion, but also possesses complementary skills and giftings, so that together we can take the church forward into the next stage in its development.



As you read through this Parish Profile my prayer is that God will speak to you clearly and stir-up in you a passion to explore this exciting opportunity. In a sense, I am reluctant to present a list of qualities because, whilst I appreciate this helps the discernment process as we seek to identify the right person for this job, I really don't want to quell the work of the Holy Spirit. I have believed for a long time that God has the right person lined up for this role and so my desire is to recruit someone who genuinely feels called to St Peter's.

Having said that, I have listed here a few of the attributes that align with our vision and strategy and that I believe will complement my gifts and skills and enable us to find the perfect match to take St Peter's forward into a new and exciting era.

We are looking for someone with a heart for God and a love of people, with strong pastoral skills and ready to develop and lead teams providing effective pastoral care. Someone who delights in seeing others released to grow and flourish as disciples who are following God's call on their life. Ideally someone with skills and experience with strategies to grow small groups. Someone who is not only committed to prayer but has a passion and skills to develop strategies and lead others in building a movement of prayer. Someone who is a gifted and passionate teacher and preacher, who can leverage the best of teaching resources and safeguard the biblical foundations of St Peter's. A natural people person with a warm and welcoming personality and a good sense of humour. Someone who is not seeking power and influence but simply wants the best for people, which is demonstrated through a willingness to serve and see people flourish. Someone who is well organised and not daunted by a challenge.

If this opportunity sets your heart racing a little faster then please read on. And be assured of my prayers as you further explore this exciting opportunity and discern God's will.

Yours in Christ,

About St Peter's - Who We Are

Our Purpose

Jesus' Family on Jesus' Mission

St. Peter's is a vibrant, flourishing, evangelical church, which is passionate about living the Gospel message in the heart of Smithills, Halliwell and across Bolton. We believe that God has called us into partnership with Him to see our parish and wider community transformed by His love.

This is achieved by the five areas of commitment.



To achieve our God-given vision to transform Bolton together we need to unlock resources and encourage everyone in their giving. We invest in teaching and opportunities to enable people to give.



At the heart of our strategy for growth is growing people through small groups, which are the engine room of the parish. Small groups are places where people can really grow in their faith, discern God's will and receive prayer and support from trusted friends.



Our passion is that every member of St. Peter's parish is engaged at some level in the mission and ministry of the church.



The heart of our faith is our obedience to Christ's call to share our faith with others. Not all are called to be evangelists but we are all called to share our faith and bring people to baptism.



Prayer is at the centre of everything we do. We desire to be at the centre of God's will in all our ministry and mission, and it is fundamental that we are guided by Him through our prayer.

Our Fellowships

The evangelical heritage of St Peter's Parish has led to continued growth throughout its lifetime, particularly evident in the establishment of four centres of worship within the parish, each containing a vibrant worshipping community but with a strong sense of shared identity of one parish with four churches.

In a typical week, St Peter's Parish has the following services:

Sunday 8.30am St. Peter's

A fellowship of around 30 members consisting of some older members and younger families who enjoy the more traditional, reflective nature of Common Worship liturgy and hymns with the organ, and the quieter environment of this service.

Sunday 10.30am St. Peter's

A vibrant, lively service with an average congregation of around 120+ people a week. It has a strong focus on worship which is led by a band. There is high quality teaching, and social interaction over coffee and lunches.

On the second, fourth and fifth Sundays this is a "Worship for Everyone" All-Age service designed to connect with families and children of all ages. It is a relaxed service where it would be easy for people to bring their friends and family.

On other Sundays it is more adult focussed, when the children are able to attend their Lighthouse groups in the parish centre.

Sunday 6.30pm St. Peter's parish-wide service

A service involving leaders, preachers and musicians from across the parish. It has a strong focus on worship, teaching and ministry, and presents an opportunity to corporately hear from God and share and discern our vision. It typically attracts around 100+ people.

Sunday 10.30am St. Andrew's

Based at the Hope Centre, St. Andrew's is a beacon of hope on the Johnson Fold estate, with a wonderful mix of local people with a strong heart for worship and a committed congregation of around 35 people.

Thursday 10.30am St. Peter's - Oasis

Launched in the summer of 2023 this exciting new service has seen significant growth with attendances around 70 people a week. The invitational format starts with coffee and conversation, building towards a shared service time with a focus on input from members of the fellowship and an invitation for all.

Sunday 10am Smithills

Smithills Fellowship is a vibrant fellowship of 70+ people with a strong community focus. In a sense Smithills is an estate church in a suburban community. It meets weekly in Smithills Dean C of E Primary School hall. It also has access to the chapel at Smithills Hall which is used for occasional services such as baptisms.

Sunday 10.30am Barrow Bridge

A fellowship in the community of Barrow Bridge with real strengths in pastoral ministry and prayer and a committed congregation of around 60 people. Services are attended by a good cross-section of the village community.



Our Parish

- Parish Population: Official population of 10,101 across 4,039 households (2021 Census).
- Socio-Economics: Includes a mix of affluent areas and areas of deprivation.
- Area Characteristics: The parish includes several major parks including Smithills Hall and the Smithills Estate, Moss Bank Park and easy access to the attractive Lancashire moors including Rivington and Winter Hill.
- Faith/Ethnicity: 84.8% identify as White. 54.4% Christian, 30.7% No Religion, and 8.3% Muslim (2021 Census).
- Schools: The parish contains three primary schools - Johnson Fold Primary, St. Peter's Smithills Dean C of E primary and Church Rd Primary, and one secondary - Smithills High School. We have strong working links with Canon Slade Secondary School but this is not within our parish boundary.



Our Buildings

St. Peter's Church

The parish church was built in the 1840s and is a Grade II Listed Building. A parish lounge, office, kitchen and toilets were added in the 1980s and a new foyer entrance in the 2020s. Recently the carpet was replaced and there are plans to replace the heavy wooden chairs with newer, lighter-weight seating. A new comprehensive sound, video and lighting system is installed. There has recently been upgrades to the driveways and footpaths, and to the toilets and disabled toilets. It has a versatile worship area and a bright welcoming atmosphere.

Barrow Bridge Mission

Barrow Bridge Mission was originally a mill repair workshop, then a cafe, and in 1930 became a mission church. It underwent extensive refurbishment over 25 years ago. Its location in Barrow Bridge is peaceful and it is a popular place to hold church retreat days.

Hope Centre

Home to St. Andrew's church fellowship, the Hope Centre has proudly nurtured over 90 years of faithful worship and ministry. Adjacent to the Hope Centre is a church-owned house which is let to tenants.

The Hope Centre is a busy hub of community and church activity. It is home to the weekly community event "Hope at the Hub", and also hosts the Bolton Repair Cafe.

St. Peter's Parish Centre

The Parish Centre, situated a few hundred metres from the parish church, is a Grade II Listed Building. Formerly a primary school, it was purchased by the parish many years ago and extensively refurbished in 2000. In October 2025 we celebrated the 25th anniversary of this with a parish-wide service recalling the involvement of many church members over the years.

The Parish Centre is home to our admin and staff team as well as many church and non-church groups, including a day care nursery and exercise groups. It is occasionally used for worship when needed and has a lift to access the upper floor. It is a highly versatile and easy accessible building with lots of modern facilities making it an attractive location for conferences and training. As a centre at the heart of the parish it rightly includes a Prayer Room which is accessible to everyone.

Our Staff

Clergy

Alan Saunders was appointed vicar in September 2022.

- Alan is an evangelist with a strong pastoral heart and a passion for mission. He is a visionary leader with a desire to advance St Peter's as a resource church for Bolton. This will be achieved by releasing him more to use his networking skills and wide experience of partnership working with churches and public sector organisations.
- He trained at St Mellitus College in London.
- He has held posts as Partnership Manager for The Message Trust and Redeeming our Communities and coordinated city region-wide mission initiatives the Big Deal and Hope 2008 across Greater Manchester. In his previous career he held senior roles in engineering, project management and corporate sales in the telecoms industry.
- He was previously curate here at St Peter's, where he spearheaded mission including the Bolton town-wide Party in the Park festival.
- Husband to Ruth, married for 30 years, and father to two adult children, Jacob and Alice.
- He loves the outdoors and is a keen walker, cyclist and kayaker. He also plays the trumpet in local symphony orchestras and a jazz band.

Josh Openshaw joined the parish in 2025

- Josh joined the team as an Interim Minister in the autumn of 2025 with the vision to plant a new church aimed primarily at students and young people in the area of Bolton University (now called the University of Greater Manchester). The plan is for Josh to serve within the parish for approximately one year during which time he will build a core church planting team to go with him as he plants the new church.
- Josh is married to Jess and has two pre-school aged children, Jude and Arthur.
- He is a keen runner and a capable musician and worship leader.

Administration and Staff Team

Amanda Blease is the Parish Business Manager and is employed for 27.5 hours per week. She is a member of St. Peter's Church, and joined our staff team in September 2009. Her responsibility is the day to day administration of the work of the parish as a whole, St Peter's Church and the Parish Centre.

Elaine Vincent is the Parish Finance Officer, employed part time. She is a member of St Peter's Church. She joined the team in 2019 and helps look after our parish finances and assists in the running of the Parish Office.

Sam Wolstencroft is our CAP (Christians Against Poverty) Centre Manager and is employed for 22.5 hours per week. Sam is a member of St Peter's Church, and has worked as our CAP manager since September 2016, having previously been our CAP Debt Coach. She works with clients, as well as coordinating our team of support workers. Our CAP Centre has been running for 15 years.

Dave Park is our full-time caretaker and worships at St Peter's or Barrow Bridge. He joined us in 2024 and works across the parish, especially in St. Peter's Church and the Parish Centre. Dave coordinates our building and maintenance team.

Children & Families Worker

This post is currently vacant, and we are currently seeking to recruit someone to take a lead in this vital area of church ministry.

Non-Stipendiary Clergy, Readers and Authroised Lay Ministers (ALMs)

Sheena Ward is a retired non-stipendiary member of the clergy team who preaches regularly. We have two licensed Readers - David Cieszynski and Linda Foster, plus several ALMs. In addition, many lay people serve as leaders, preachers and in leadership roles.





Our Town

- Bolton is situated 10 miles north-west of Manchester and is the administrative centre of the wider Metropolitan Borough of Bolton. It has a population of just over 300,000 people and is the largest town in Britain.
- “From Fred Dibnah to Formula 1” might be a slogan defining Bolton’s industrial heritage. The nineteenth century cotton mills brought jobs and industrialisation to the town with Samuel Crompton’s Spinning Mule and the introduction of steam-powered engines. Those with long memories might remember steeplejack Fred Dibnah climbing the tall chimneys that served the mills, but most of these are no more. The University of Greater Manchester (formerly University of Bolton) hosts the UK’s only National Centre for Motorsport Engineering.
- Bolton boasts a vibrant cultural scene, including the Octagon Theatre, Bolton Little Theatre, and the Phoenix Theatre Company. It has been a popular filming location for recent TV and film, such as “Peaky Blinders,” and “Last Tango in Halifax.”
- The Le Mans Crescent complex houses the central library, museum, art gallery, and Town Hall, and is the focal point of a new Cultural Quarter. Notable institutions include the Bolton Museum and Art Gallery, and the Bolton Steam Museum.
- The town is home to Bolton Wanderers Football Club, a historic founding member of the Football League (formed in 1874), and has a deep-seated local following.
- Bolton hosts England’s only full-distance IRONMAN race, known for its iconic spectator support and incredible North West English bike course scenery.
- More information about the town and surrounding area can be found on the visit Bolton website.

St Peter's Ministry - What We Do

Worship Services

The style of worship across the parish is varied and we aim to provide everyone with a place to worship which suits them.

Traditional style

For those who prefer a more traditional, liturgical style the Sunday 8.30am service at St. Peter's would be a good place to start. If that feels too early in the day, then Oasis on a Thursday morning offers a similar style, with the opportunity for fellowship over a cuppa beforehand. These services tend to use more traditional hymns with organ or piano accompaniment.

Family oriented worship

The 10am service at Smithills and the 10.30am at St. Peter's and Barrow Bridge offer Worship for Everyone Services on two Sundays each month when our children's groups are not running. The other weeks they will have an adult focus aimed especially towards newcomers. Music is chosen from contemporary songs and led by a band of musicians, which includes young people one Sunday per month at St. Peter's.

Deeper engagement

For those who are ready for more, the 6.30pm parish-wide service at St. Peter's allows time for worship, teaching and ministry. We generally use contemporary music with a block of sung worship and a band drawn from across the parish. The talk lasts around 30 minutes and there is time and space for ministry afterwards.

Discipleship and Evangelism

Alpha

We have a rolling programme of Alpha courses three times a year in the spring, summer and autumn. Group members often choose to continue to meet regularly after the course and become seeds for new Life Groups.

Life Groups

There are twelve Life Groups meeting regularly across the parish, some weekly, some fortnightly. Meetings happen during the daytime as well as evenings and members value the support provided through these groups.

Men's and Women's Ministries

Soul Sisters is our parish-wide women's group, which meets monthly. Activities include countryside walks, crafting, bring and swap events and testimony evenings.

Various men's groups arrange walks and barbecues, prayer and discussion on a regular and ad hoc basis.

Other

Groups of people attend Spring Harvest each Easter. We hold a parish-wide weekend away bi-annually, which is typically attended by over 140 people from all fellowships. We make use of literature from LICC in small groups or to guide our preaching in whole-life discipleship.

Baptism

We have recently purchased our own baptism pool and offer opportunities for baptism by full immersion, some after completion of the Alpha course.





Youth and Children

At St Peter's we love welcoming families and children of all ages. Our hope is to build a community that supports parents and carers; we also hope to create an environment of fun where children and young people can make friends, flourish in their relationship with Jesus, and learn to share His love with their friends and communities.

Our children's ministry is called **Lighthouse** and runs at three of our worship centres on Sunday twice each month. In addition, we have a pre-school group called **Twinklers** at St Peter's Church. The work is supported by an amazing team of volunteers who are committed to seeing children grow in their spiritual lives.

We have a variety of midweek groups for children and young people:

- **Little Wiggles** at St Peter's Parish Centre and **Tots on Tuesdays** at St Andrew's Hope Centre are our baby and toddler groups.
- **Ignite** at St Peter's Parish Centre is a club running fun-packed sessions for Key Stage 2 aged children.
- **Tread** meets at St Peter's Parish Centre and is a thriving group for high school aged young people.
- We have two **Discipleship Groups** that meet fortnightly, one for girls and one for boys of high school age.
- We are also taking steps to set up a new midweek group called **Spark** for Key Stage 1 aged children.

We host regular **social events**, such as the annual Light Party, that welcome families from the community to help children introduce their friends to their church family. We take our Tread youth group to DTI (Dreaming the Impossible), a youth gathering at Staffordshire Showground each year.

St Peter's is a registered centre for the delivery of the **Duke of Edinburgh Award** scheme. We have a volunteer team who enable young people to work towards these awards every year.

Our passion is to mentor and involve young people in all aspects of church life. We have a youth band at St Peter's Church, young leaders volunteer in many of our children's groups, and young people work with our tech team to run AV at some of our services.

We partner with the **Places Project**, a 5-year project led by Manchester Diocese to pioneer innovative projects to support churches in reaching out to children and young people. One of their team is placed part-time with St Peter's: they are part of the chaplaincy team at Canon Slade CE High School and lead our Tread youth group. Other team members support our Ignite children's club and activities in our three local primary schools.

We also partner with organisations to enhance our outreach to children and young people. Last year we had a mission team of three young adults from PAIS UK based at St Peter's. We have recently hosted mission visits by the Anglican Youth Fellowship Band of Uganda, and the Message Trust; we are making plans for further visits in the coming months.



Pastoral Care and Local Outreach

Many groups meet across the parish meet regularly to provide support to members of our fellowship and also to our community. These include:

Dementia Support Group meets in the Parish Centre and provides support to those suffering from dementia and their carers and families, with songs, games and the chance to chat over a cuppa.

Adoption and Fostering a 'Home for Good' support group meets monthly in the Parish Centre to support those families involved in this area and those interested.

Hub at the Hope is a weekly gathering on Wednesdays between 9am and 1pm at the Hope Centre. It is a place to welcome local people and provide space for friendly fellowship, activities, hot drinks and maybe cake too. **Bolton Repair Café** is part of the Hub and meets on the third Wednesday of every month.

Prayer Zone is a one hour monthly parish-wide prayer meeting which moves around the fellowships each month across the parish.

Weekly Prayers with the staff team is every Wednesday morning, and is open to others to attend once a month.

Christians Against Poverty (CAP) Our CAP centre has been in operation for 15 years and takes clients from the area. It is led by Sam Wolstencroft, our employed CAP Co-ordinator and she leads a team of volunteer helpers and befrienders.

24-7 Prayer is well supported in the parish, with many people using the Lectio 365 app in their daily quiet times. We also link with 24-7 Prayer when we organise a week of prayer for a variety of causes.

Community Connections

We have strong links with our local communities, based around our different worship centres across the parish. As we meet members of our local community at these events we have opportunities to share and demonstrate the love and gospel of Jesus as we interact with them.

Schools

As stated earlier we have strong links with local schools - two primary schools and a secondary school. Smithills fellowship meet in St. Peter's Smithills Dean Primary School and the head teacher there, Matt Harding, leads the 10.30am Worship for Everyone service at St. Peter's on a regular basis. Church Road Primary School is not a Church of England school but, being situated adjacent to the parish centre, we find we have close links there, for example with assemblies, and church members going into school to listen to children read. Canon Slade School is a Church of England Academy with whom we have close ties, although it is situated outside the parish. We run lunch groups, get involved with worship, organise mission visits, and Alan Saunders is a member of the governing body.

Coffee Drop-In

Initially aimed at CAP clients, the Monday morning coffee drop-in at the parish centre is now open to all and provides a warm space for a hot drink and cake to any who would like some company.

Cafe on the Green

About four times a year the team at Smithills host a pop-up cafe in the school, serving tasty breakfasts, snacks and fabulous cakes. Money raised from here supports mission through church mission partners in Kenya.

Annual Duck Race

Barrow Bridge Mission is built alongside Dean Brook which provides a lovely location for an annual duck race, organised by the church and a very popular public event.

Annual Bonfire

Another popular Barrow Bridge event is the annual bonfire and fireworks, hosted in the local car park. This is always a sold-out event and very popular with residents of Barrow Bridge village and those from further afield.

Christmas Market

Now in its 12th year the Christmas street market on the Smithills estate has become a wonderful tradition. It is organised by a team from the Smithills Fellowship, and provides all sorts of craft gifts for sale and a wide variety of food offerings to tempt the hungry on a cold and sometimes wet Saturday in December.

Allotment

The church has its own allotment on Church Road where interested folk meet regularly to work and share together.

A Venue for Culture

St. Peter's Church has been used for concerts by bands unrelated to church for concerts. Recently a concert in aid of Create Bolton, one of our mission partners, hosted the Midweek Sax band and concert band. In September it was also the venue for a play by the Marco Players, a well-known Bolton amateur dramatic group, when they performed Bill Naughton's All in Good Time for four evenings.



Global and Local Mission

Each fellowship supports its own charities in different ways.

St. Peter's Parish has a long and rich history, both financial and practical, of supporting missions, by sending missionaries out over several decades. Many of the causes come from direct personal connections. St Peter's church has a group called NIM (National and International Ministries) which is managed by a team of dedicated people. Individuals give directly into that fund, which results in significant sums available for the supported causes. The other three fellowships tithe their income directly to the missions which they support.

The missions supported by the parish include Release International, Middle East Concern, Education India, Musalaha, Daylight Project, Interserve GBI, Good News for Romania, Kijabe Hospital in Kenya, Bellevue Church in Zimbabwe, Oasis Orphanage in Uganda, Urban Outreach and Create Bolton as well as supporting individuals working in Algiers, Nepal and the Middle East.

Accessibility

We have a parish-wide team focussing on how we make our buildings, services and activities more accessible to people with disabilities. This has resulted in the development of new guidance and resources. We see this as an area of continued development, with a vision to be a centre of excellence to enable people of all abilities to be part of the fellowships and help them to participate fully in the life and worship of what church has to offer.



The Future of St. Peter's - Where We're Going

Five Key Areas

Since Alan started as Vicar in 2022 the focus has been around what it means to be part of the church, which gave rise to **"Jesus Family on Jesus' Mission"**. We then focused on the person of Jesus and we are now moving on to look at "who is our neighbour" and, in greater depth, how we move into mission.

As a part of this exciting new phase in the life of St. Peter's Parish Alan sees his role broadening to include the bigger picture of Bolton, and the role of St. Peter's across the town focusing on young children, families and older people. With this opportunity comes the challenge of managing the day-to-day operations of the parish. We see the Associate Minister's role as key to building up our core ministry in this area.

Giving - the positive news is that our finances are almost at break even, with a slight deficit for the past year, and we are paying our Parish Share in full. However, we need to see an increase in income in order to provide new team members who will develop the areas mentioned through increased income and external sources of funding.

Meet - the key to delivering our small group strategy to see an ongoing increase in the number of people in small groups is to improve the quality of leadership. There is a need to develop and embark on a programme of support, mentoring and training of small group leaders.

Serve - we are keen to continue with our aim of giving everybody in the parish the opportunity to serve. In order to achieve this, we recognise we need to develop a wider range of ways in which people can serve.

Baptise & Share - it is everyone's responsibility to keep sharing their faith with others and to encourage other people to do the same. We need to continue to develop teaching and resources to equip people to share faith effectively and develop new mission opportunities to reach out to our neighbours across Bolton.

Pray - we want to build greater intentionality in our prayer ministry across the parish. This will be achieved through support and training for prayer ministry teams, regular prayer events and meetings, and weeks of prayer. We have a prayer room in our Parish Centre, and seek to equip people to grow in their commitment to personal prayer and prayer in small groups.



"Seeking to be shaped and renewed by the Holy Spirit."





Church Plant

We are excited to be pioneering a key project in partnership with Manchester Diocese to plant a new resource church in Bolton town centre. Josh Openshaw recently joined the team as a Pioneer Minister and we are working together to discern and build a church planting team to go with him.

This project will be supported by funds from the National Development Fund from the Church of England commissioners. The plant will have a focus on young adults and will be located in the vicinity of Greater Manchester University in Bolton. The plant is likely to take place in early 2027.

We are also seeking to develop our outreach to young people across the town. This will be achieved by providing more sessions in local schools and outreach opportunities in the community in addition to our church based youth groups. To develop these programmes we are in the process of recruiting a Children's and Youth Ministry Lead.

Front Lines

All fellowships are active in their local communities and continue to evaluate the most effective ways of reaching out. We encourage people to live well for Christ and be disciples on their own front lines.

Ministry to Older People

We have a rich variety of activities for older people across the parish including the midweek Oasis service, strength and balance class, friendship group for dementia, Hub at the Hope, Open Door for older ladies, and art groups. We also host the local history society. Through all these we recognise that we have a real strength of ministry to older people.

Parish Centre

The Parish Centre celebrated the 25th anniversary of its redevelopment last year. In recent years the centre has grown to be a thriving centre of activities and outreach. There are over sixty groups and organisations regularly using the building, ranging from work with pre-school children to support for older people, and everything in between. The Parish Centre has also become self-sufficient financially and there is a programme of refurbishment work underway. We see the Parish Centre as a flagship of our outreach to the local community.



Appendices

Housing

The Diocese has recently purchased a house for the Associate Minister at 65 Smithills Croft Road, Bolton BL1 6TY.

The estate agent's brochure can be viewed here
<https://stpetersparish.info/wp-content/uploads/2026/01/65-Smithills-Croft-Rd-Bolton.pdf>

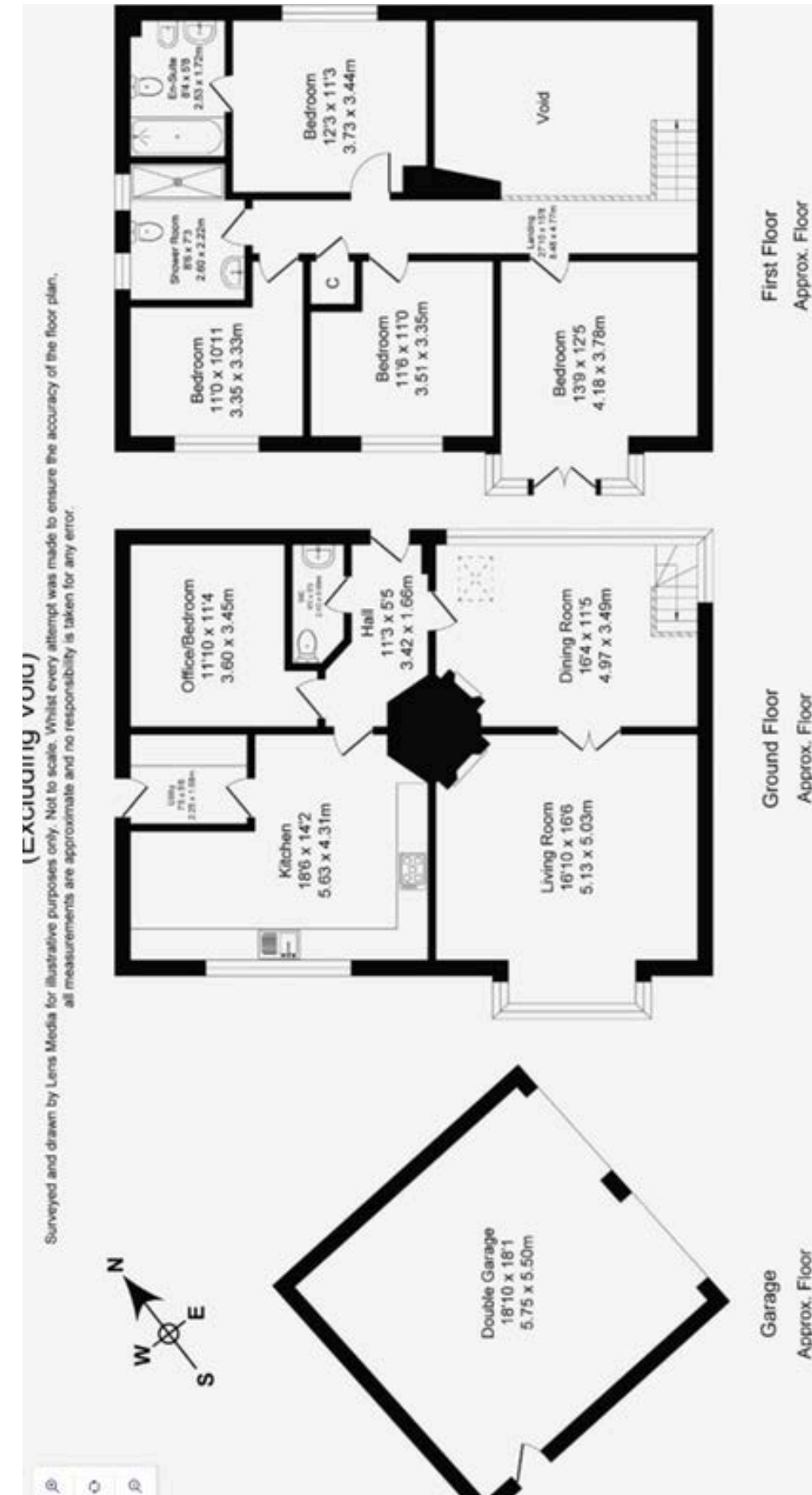

Governance

The PCC has a wide variety of groups and activities across the parish and to support it in its governance responsibilities a structure of subcommittees exists. The subcommittees provide the opportunity for people not on the PCC to be involved, which in turn helps recruitment of future PCC members and provides for people with specialist skills to support the work in these areas. This means the subcommittees can give the time, focus and expertise in these areas of governance and provide guidance and recommendations back to PCC in the decision making process. To enable the smooth operation of these subcommittees and provide clarity of responsibilities and delegated authority each subcommittee has a Terms of Reference document which has been adopted and agreed by the PCC.

St Peter's PCC Sub-Committees

| Sub-Committee Name | Chair |
|---------------------------------------|-------------------|
| Standing Committee | Alan Saunders |
| St Peter's Leadership Team | Chris Ward |
| Smithills Fellowship Leadership Team | Ross Pyle |
| St Andrew's Leadership Team | Diane Ball |
| Barrow Bridge Mission Leadership Team | Daniel Caffrey |
| Buildings and Maintenance | David Park |
| Quinta Team | Sam Wolstencroft |
| CAP Steering Group | Alan Saunders |
| Accessibility Group | Helen Stainthorpe |
| Staffing Committee | Cath Hargraves |
| Worship Team | Keir Simister |
| National and International Ministries | Phil Weaver |
| Leadership Chairs | Alan Saunders |
| Safeguarding Team | Chris Winstanley |
| Fundraising Team | Peter Caffrey |

Finances

For the last full year for which accounts are available, January to December 2024, the accounts show:

Total parish income £497,285. Total Parish Expenditure £504,114.

PARISH INCOME BY CATEGORY 2024

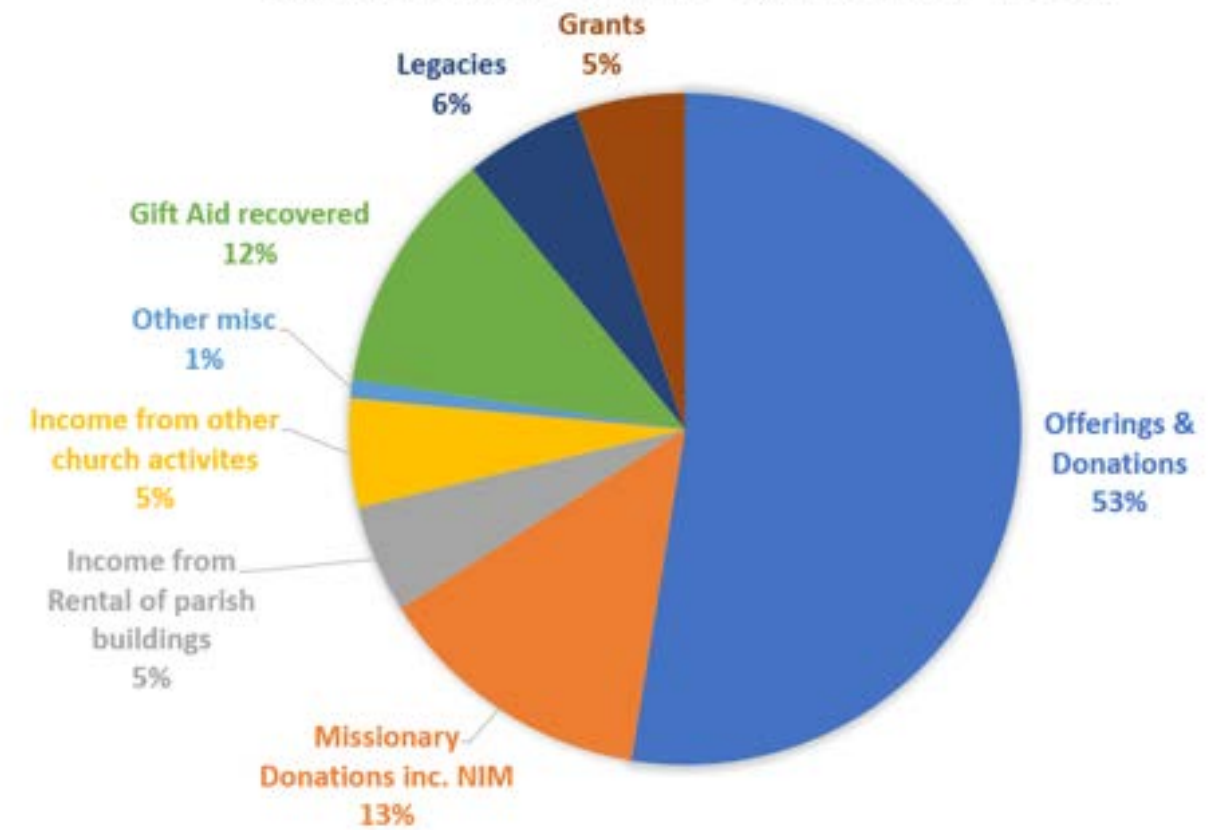

PARISH EXPENDITURE BY CATEGORY 2024

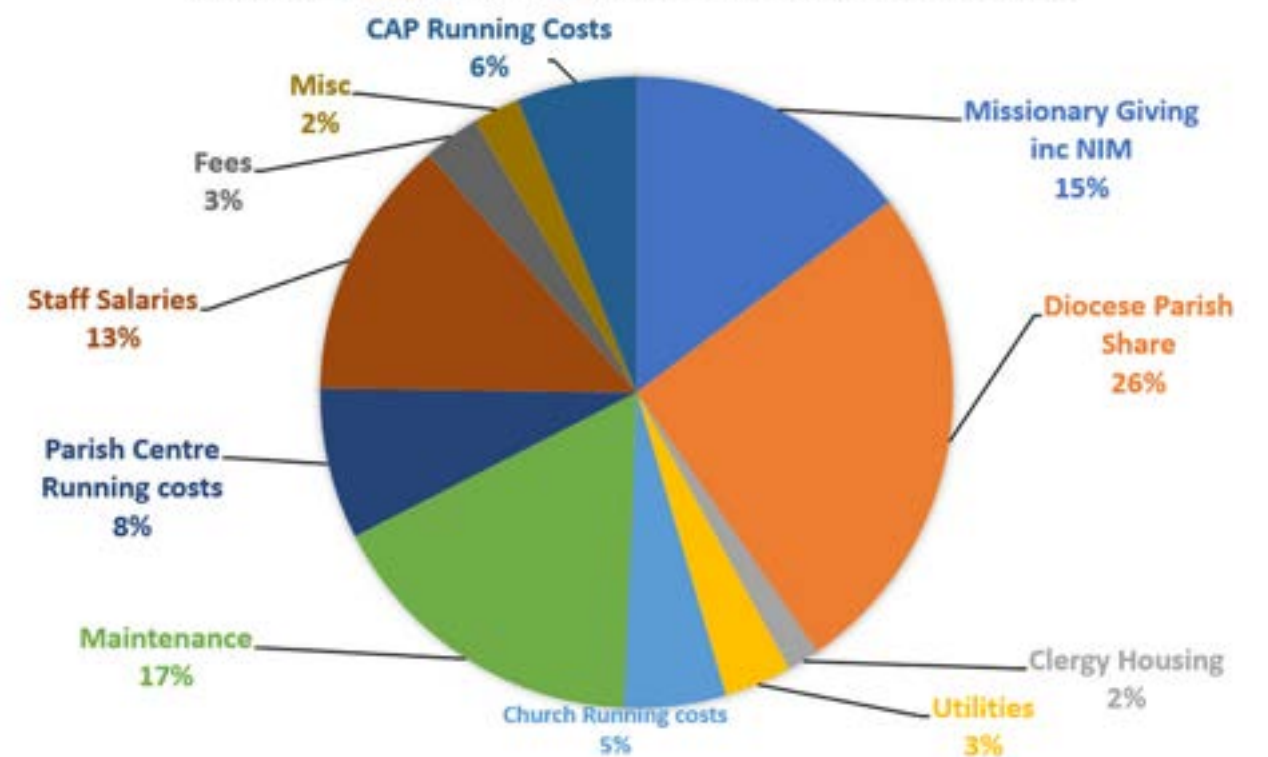

Manchester Diocese

The Diocese of Manchester is a vibrant and creative community committed to being a worshipping, growing, and transforming Christian presence at the heart of every community. Guided by a "culture of hope," the diocese is currently engaged in an inspiring strategy for 2030 that prioritizes parish renewal, church revitalisation, and a passionate commitment to "growing younger." It is a diocese that actively invests in developing missional leaders—both lay and ordained—while championing racial justice and environmental stewardship. It is a diverse and inclusive diocese that honours different traditions and perspectives, all united by a shared passion for Jesus Christ and a clear vision to see the church grow in both numbers and spiritual depth. More info can be found here: www.manchester.anglican.org/our-diocese/our-vision/.

We enjoy a strong partnership with the diocese, receiving regular visits from the Director of Mission and Ministry, Phil Cansdale, and Area Dean Simon Cook, collaborating with them on the church plant, working with the Places project (in children and schools' work). The Bishop of Bolton, Matthew Porter led the teaching at our parish weekend away in 2025; he occasionally preaches at our regular services and meets regularly with Alan.

As a well-resourced church in Bolton we provide a worship band for some mission community services and enable parishes with fewer resources to collaborate on mission work.

General Information

Further information

Further information about St Peter's parish can be found on our website www.stpetersparish.info including details about activities mentioned in this Profile, current preaching programmes and forthcoming courses and events.

Any requests for information should be addressed to the Vicar, Rev Alan Saunders, at alan@stpetersparish.info or the Parish Business manager, Amanda Blease, at office@stpetersparish.info.

Communications

In addition to its website, St Peter's has a [Facebook page](#) and [YouTube account](#).

